



UNIVERSITY OF
BIRMINGHAM

UNDERGRADUATE OPEN DAYS



#hellobrum

Information line: 0121 414 3374

www.birmingham.ac.uk/opendays

THE TIMES
THE SUNDAY TIMES

**GOOD
UNIVERSITY
GUIDE
2016**

UNIVERSITY
OF THE YEAR
FOR GRADUATE
EMPLOYMENT

Contents

Welcome	3
How to reach the University	4
Campus developments	5
How to make the most of your day	6
Check-in at open day	7
Tours and activities	8
Find out about our accommodation	9
The city of Birmingham	11
General events timetable	12
Subject events timetable	15
Refreshments	30
Day planner	32
Edgbaston campus map	Back cover

SHAPE YOUR FUTURE



AT THE UNIVERSITY OF THE YEAR FOR GRADUATE EMPLOYMENT

The University of Birmingham has been named University of the Year for Graduate Employment in *The Times* and *The Sunday Times Good University Guide* 2016.

Join the conversation

For updates and advice on what's happening throughout the day and to share your views of our open day and the University, follow us on social media

#hellobrum

 @unibirmingham
 www.facebook.com/unibirmingham
 @unibirmingham

Feel free to ask us any questions and make sure you share your thoughts and photos of the day #hellobrum

Mobile app

Find your way around the open day by downloading our FREE open day app from the iPhone App Store, iTunes or Play store (search UoBopenday), or visit www.birmingham.ac.uk/contact/app-store.aspx

You can use the interactive app to:

- ☐ Find your way around campus using the interactive campus map
- ☐ Plan your programme of activities and sessions using your personalised scheduler
- ☐ View the accommodation tour walking map
- ☐ Navigate to information and registration points on campus
- ☐ Access travel and parking information
- ☐ Link to social media pages

Available to download at the beginning of June

Free Wi-Fi

Please log on to the open day wireless network using the password **uniofbham**



Welcome



WELCOME TO OUR GLORIOUS CAMPUS. WE REGULARLY ATTRACT MORE THAN 20,000 VISITORS TO CAMPUS ON OPEN DAYS AND, AS YOU LOOK AROUND TODAY, IT IS EASY TO SEE WHY. OUR BEAUTIFUL, GREEN 250-ACRE ESTATE OFFERS YOU A SAFE, FRIENDLY ENVIRONMENT WITH ALL THE FACILITIES OF A SMALL TOWN AND IS JUST A FEW MINUTES FROM THE VIBRANT CITY CENTRE.

This open day will give you a taste of our university and provide you with all the information you need to make an informed choice about where to study. There are talks and displays as well as the opportunity to meet the students and staff who live and work here. Please make time to talk to them and ask lots of questions, and we hope you leave with a picture of the real Birmingham.

As you explore campus today you will see that Birmingham is going through an exciting and transformational redevelopment, the most significant our historic campus has seen since its original buildings were completed in 1909.

The University is currently undergoing a £500 million estates development programme and over the next five years we will continue to invest and add to our exceptional facilities for

students, researchers, and the wider community to enjoy.

Birmingham is acknowledged as one of the world's greatest universities. We are proud to offer an outstanding educational experience delivered by excellent teachers in a global university renowned for its research and teaching. Here you can continue to unlock your potential knowing you have access to and support from some of the finest academic minds in the world.

Preparation for your future career is likely to be a key consideration as you choose a university. From tailored careers guidance and global internship opportunities to an accredited personal skills programme and mentoring from our impressive alumni network, the wide range of options available to you will ensure that you are uniquely prepared for life

after university. So it is no surprise that we have been named University of the Year for Graduate Employment in *The Times* and *The Sunday Times Good University Guide 2016*. An accolade which places Birmingham as the UK's number one university for securing a graduate-level job.

I hope that you enjoy your visit today and gain a valuable insight into what it is like to study at a leading global university. Take home with you the knowledge that if you choose Birmingham you will be choosing to become part of one of the world's great universities. We will then be delighted and privileged to welcome you as Birmingham becomes your university.

With best wishes
Professor Sir David Eastwood
Vice-Chancellor

How to reach the University



CATCH THE TRAIN FROM BIRMINGHAM NEW STREET STRAIGHT TO UNIVERSITY STATION IN EIGHT MINUTES

The University has a very limited number of car parking spaces on open days and as the majority of visitors will be unable to park, we strongly recommend where possible, for visitors to use public transport.

By rail

Being the only university in mainland UK with its own station, the easiest way to reach the University is by train. Most cross-country services to Birmingham arrive at Birmingham New Street station and up to six trains an hour depart for University on the cross-city line (final destination Longbridge or Redditch). The journey time usually takes less than ten minutes, while the centre of the main campus is a five-minute walk from University station. Student ambassadors (wearing lime green shirts) will be present at Birmingham New Street station to direct you. Your final destination for purchasing train tickets will be 'University (Birmingham)'.



LIMITED PARKING



Parking on campus

Parking on open days is extremely limited and the majority of visitors will be unable to find a space on campus. We therefore recommend that visitors use public transport to reach the University or find alternative parking in and around the city. The University has three main car parks: North East (B15 2SA), North (B15 2SB) and Pritchatts Car Park (B15 2QU) (free of charge); parking will also be available at the West Car Park (near the Medical School) on Vincent Drive on Saturday only, however please note that these are used by staff and students and fill up very quickly and therefore we cannot guarantee a space for visitors.



PARK AND RIDE

Park and ride

In addition to University parking there is an overspill park and ride car park with some limited parking. This is based at King Edward's School playing field (B29 7JX – the playing fields is a left turn if approaching from the city centre, just before the Eastern Road turn) on the Bristol Road. Park and ride will be operating on a first-come, first-served basis. Shuttle buses to and from the University will be running throughout the day, dropping off and picking up from outside University Centre (building R23 on the map on the back page).

The first park and ride will leave King Edward's School playing field at 8.30am. The last bus will leave University Centre at 4.30pm. There is no charge for the park and ride car park.

USEFUL LINKS



- www.birmingham.ac.uk/opensdays/travel
- Travel information, maps and directions: www.birmingham.ac.uk/directions
- National train information: www.nationalrail.co.uk

Campus developments

THE UNIVERSITY IS INVESTING £300 MILLION OVER FIVE YEARS IN NEW FACILITIES FOR STUDENTS AND RESEARCHERS. IN THE PAST YEAR WE HAVE OPENED A NEW STUDENT HUB IN OUR ASTON WEBB BUILDING; A BRAND NEW HALL OF RESIDENCE, CHAMBERLAIN, AND AN INSTITUTE OF TRANSLATIONAL MEDICINE.

We have even more projects in the pipeline, some of which you will benefit from the minute you start as a University of Birmingham student.

The new sports facility, 360 Sport & Fitness, will open on campus this September. It will be an iconic sporting venue and will feature an exceptional range and quality of facilities including a 50-metre pool, an arena sports hall, 200+ station gym, six squash courts, ten-metre climbing wall, a performance gym and much more! 360 Sport & Fitness will cater for everyone in the student and local community whether you're a beginner or an elite athlete.

Visit our outstanding new library today (also opening later this year), for a sneak preview of the state-of-the-art facilities for all students. Located in the centre of campus, study spaces

in the new library will benefit from stunning views across campus and light and airy areas to work. All study spaces will allow students to work from multiple devices and a variety of flexible spaces will support students in all methods of study, from group work to independent self-study.

The new Green Heart will be a vast landscaped park at the heart of campus, with a range of spaces for activities ranging from ceremonial occasions to public performances. In addition to our new Chamberlain hall of residences, we are creating a new residence for 178 students near our sports pitches at the Selly Oak entrance to campus, while the Collaborative Teaching Laboratory will bring together practical teaching activities across a broad range of science and engineering disciplines.

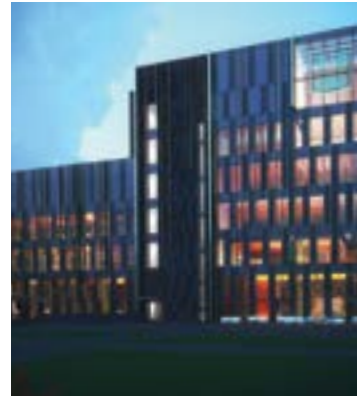

How to make the most of your day

WHAT'S ON OFFER?

IN THE ASTON WEBB AND BRAMALL BUILDINGS YOU WILL FIND A WIDE RANGE OF SUBJECT-SPECIFIC STANDS AS WELL AS STANDS RELATING TO SPORT, WELFARE, ACCOMMODATION, FINANCE, CAREERS AND OTHER AREAS. VENUES TO VISIT ARE:

- GREAT HALL, GROUND FLOOR,
ASTON WEBB BUILDING

R6
- ROTUNDA, 1ST FLOOR,
BRAMALL MUSIC BUILDING

R12
- THE DOME ROOM, 3RD FLOOR,
BRAMALL MUSIC BUILDING

R12

Talks on a range of subjects take place throughout the day. The timetables for talks can be found from page 12 onwards.
Please note: all talks last approximately 30 minutes.

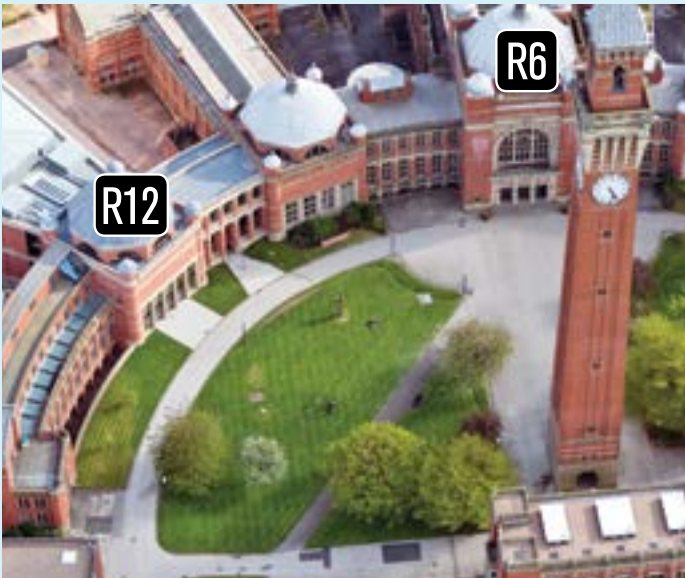

Our friendly student ambassadors are dotted around campus and here to answer your questions and help you make the most out of your day.

Check-in at open day

CHECK-IN

All visitors are required to check-in on the day. In order to do so, please pre-register online at www.birmingham.ac.uk/opendays. In the days leading up to open day you will receive an email from us with your own personalised event ticket. The ticket will include a QR code which we will use to check you in on the day. Below is a step-by-step guide to your on the day check-in.

- 1** WHEN YOU RECEIVE YOUR EVENT TICKET VIA EMAIL, PLEASE **PRINT IT OFF** IF YOU HAVE ACCESS TO A PRINTER, AS HANDING YOUR TICKET IN MAY HELP YOU BEAT ANY QUEUES. ALTERNATIVELY WE CAN SCAN YOUR TICKET FROM A SMARTPHONE.
- 2** **BRING YOUR EVENT TICKET** TO THE UNIVERSITY OF BIRMINGHAM OPEN DAY.
- 3** WHEN YOU ARRIVE ON CAMPUS, **VISIT ONE OF OUR FOUR CHECK-IN/ INFORMATION POINTS** (SEE CAMPUS MAP FOR LOCATIONS) AND **HAND IN YOUR EVENT TICKET**.*
- 4** AS RECEIPT OF YOUR CHECK-IN ON THE DAY, YOU WILL **RECEIVE** A UNIVERSITY OF BIRMINGHAM BAG TO HELP YOU COLLECT INFORMATION/ LITERATURE THROUGHOUT THE DAY.
- 5** IF YOU NEED TO RUSH OFF TO YOUR FIRST TALK OR ACTIVITY WHEN YOU ARRIVE ON CAMPUS, DON'T WORRY, **YOU CAN CHECK-IN** WHEN YOU HAVE A SPARE FEW MINUTES.
- 6** WE ALSO HAVE **THREE INFORMATION POINTS** THAT YOU CAN VISIT TO PICK UP A **PROGRAMME** AND ASK ANY QUESTIONS THAT YOU MAY HAVE.

*This will allow you to 'check-in' to the open day.

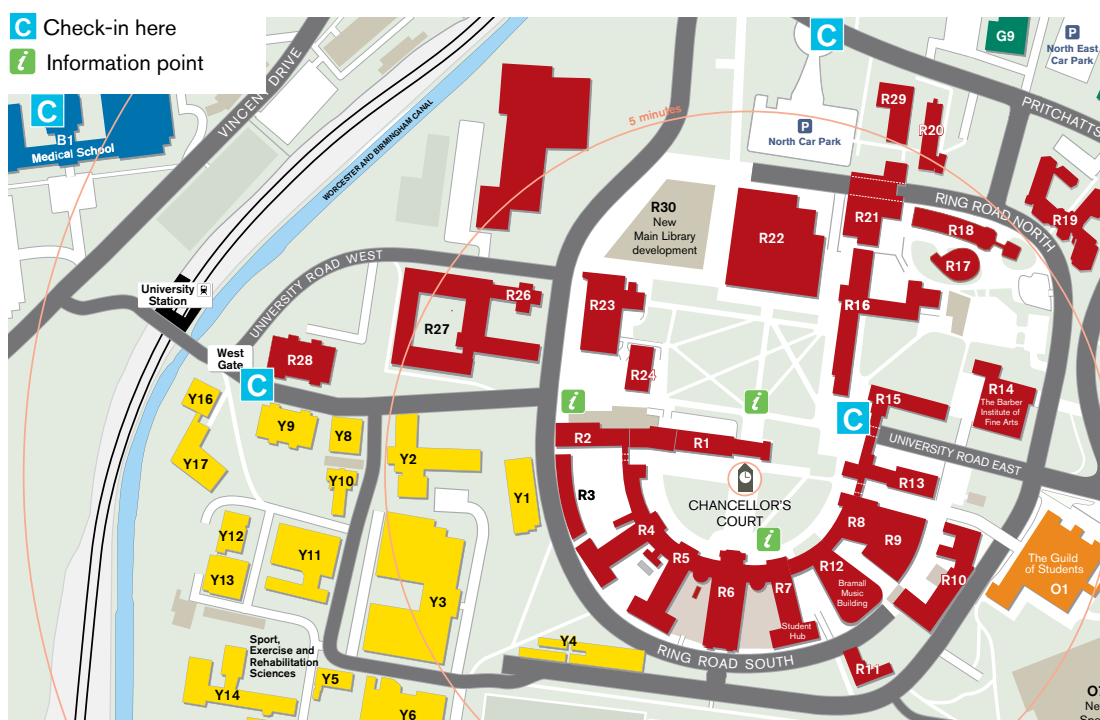

Tours and activities

CAMPUS TOURS

Guided walking tours of the main campus take place throughout the day, starting at 9.00am. They last between 45 minutes to an hour. The Campus Tour tent is situated in Chancellor's Court.

NEW LIBRARY

Our brand new library opens this summer – for an exclusive sneak peek, head to building R30 on the campus map, 9.30am–3.00pm. Our staff will be on hand to answer all the questions you may have about the library and our services.

BIG BRUM BUS SIGHTSEEING TOUR

Join our live, guided open top bus tour! Tickets are free and can be collected from the Aston Webb Reception (building R6 on the map) on a first-come, first-served basis. Please see the general events timetable on page 12 for details.

MUSIC SOCIETY

The University of Birmingham Music Society is the oldest and largest music-making body on campus with over 700 current members, running orchestras, bands and choirs for all. Find us in the Bramall Music Building or online at www.uobmusicsociety.org.uk

The Barber Institute of Fine Arts

Join our free guided tour of the galleries, the permanent collection and the latest exhibitions and displays. Meet at 12.00noon in the foyer at the Barber Institute (building R14 on the map), underneath the portrait of Lady Barber.

Opening hours

11.00am–5.00pm/Tour at 12.00noon
Admission is free
www.barber.org.uk

University of Birmingham Sport home to 360 Sport and Fitness

At Birmingham, we believe sport and fitness is for all, from complete beginner to elite athlete. This September we will open our brand new, £52 million sports centre: 360 Sport & Fitness, which features world-class facilities and its right on your doorstep!

The University also has 53 competitive sports clubs and ranks in the top five universities for sport in the UK.

Come along to the Sport marquee (outside the Guild of Students) to see 360 Sport & Fitness in its final stages of building and chat to our students, athletes and coaches.



Visit the Guild of Students – Your students' union

We're here to make sure you get the best from Birmingham! As a charity and the students' union for more than 30,000 students, we represent you to the University and other organisations about your academic and university experience. We're your voice on the issues that matter most to you.

To find out more, attend a student life presentation followed by an optional tour of the Guild. Please see General events timetable on page 13 for details.

Find us online at

www.guildofstudents.com
and follow us on Twitter
@GuildofStudents

INVESTMENT IN OUR STUDENTS' CAREERS

Our specialist staff offer careers guidance tailored to individual subject areas. We provide help to source and secure internships in the UK and overseas and our bursaries provide financial support to students undertaking work experience. Our mentoring schemes give students the chance to learn from some of the University's most successful alumni. To find out more about our sector-leading employability services; why not attend the talk 'Time to make the most of your Birmingham degree: internships, work experience, bursaries, and graduate career success' (please see page 12 for details)

Find out about our accommodation

A SELECTION OF ACCOMMODATION FOR FIRST-YEAR STUDENTS IS AVAILABLE TO VIEW AT OUR VALE STUDENT VILLAGE – ONE OF OUR THREE ACCOMMODATION VILLAGES BEING A SHORT WALK FROM CAMPUS. AVAILABLE TO VIEW AT YOUR LEISURE ARE EXAMPLES OF CATERED, SELF-CATERED, EN-SUITE AND SHARED BATHROOM FACILITIES WHICH WILL GIVE YOU A FEEL FOR STUDENT ACCOMMODATION HERE AT BIRMINGHAM.



Activity	Location/Travel	Description
Accommodation viewing at the Vale (Chamberlain, Maple Bank and Mason are available to view as well as the Vale Hub)	Walking map Pick up a walking map from an information booth and walk one of two marked routes to the Vale	Allow 15–25 minutes to walk and 45 minutes to one hour to view (you can view all examples or if you're limited on time choose your most favoured option)
	Bus to accommodation Buses depart from outside the Barber Institute of Fine Arts (building R14) and drop visitors at Chamberlain at the Vale Village. To return to campus, there is a bus stop outside Mason accommodation. Buses run between 9.00am and 3.15pm	We expect the buses to accommodation to be popular with queues likely, especially between 11.00am and 2.30pm. If you experience queues, you may find that walking to the Vale is quicker. Allow approximately 30 minutes to queue/travel and 45 minutes to one hour to view (you can view all examples or if you're limited on time choose your most favoured option)
Accommodation talks – hear about the full range of student accommodation and the application process	See general events timetable from page 12	Talks last 30 minutes
Display and Information desk – drop in to chat informally to our Accommodation staff and pick up an Accommodation brochure	See general events timetable from page 12	Informal chat

More information on accommodation can be found at www.birmingham.ac.uk/accommodation along with 360-degree tours of all our accommodation.

Follow us on Twitter @livingatbham and find us on Facebook www.facebook.com/birminghamaccommodation



WINTERBOURNE HOUSE AND GARDEN

This is a unique heritage attraction and the perfect place to escape the crowds on open day. This attraction will be open from 10.00am–5.30pm on Friday and 11.00am–5.30pm on Saturday (last entry 4.30pm) and entry is free for prospective students and £1 for parents and guests.

ACTIVITIES AND TALKS FOR PARENTS

Parents may be interested in attending our 'Parents' Survival Guide' talk which covers all you need to know about supporting your son or daughter through their transition to university. Details of time and location, as well as talks on Careers, Finance and other topics, can be found at the general events timetable from page 12.

MATURE STUDENTS

A mature student ambassador will be available to answer queries and have a chat about undertaking a degree as a mature student. Find them at the Admissions stand in Aston Webb (R6 on the map).

ACCESS TO BIRMINGHAM (A2B) SCHEME

If you are from a state school in the West Midlands and are a student, or supporting students with university applications, come to the Admissions stand in the Great Hall, Aston Webb Building (R6 on the map) to discover how the A2B scheme can help students from disadvantaged backgrounds make the transition to university life.

Learn more
www.birmingham.ac.uk/a2b

VISITORS WITH DISABILITIES

We encourage students with disabilities to visit and study at the University and have implemented a programme of accessibility adaptations on campus. This includes the installation of lifts and accessible toilets and improved signage. All new buildings and major conversions are being designed with accessibility in mind. A mobility map is available from the Aston Webb Reception (R6 on the map), which gives an overview of the Edgbaston campus showing the main access routes for wheelchair users. Blue Badge holders should arrive at the East Gate where security personnel will direct you to the nearest disabled parking spaces.

Prospective students with a disability are encouraged to visit the Disability and Learning Support and Mental Health Service desk in The Great Hall, Aston Webb Building (R6 on the map). For more information please visit our website at: www.birmingham.ac.uk/students/support/disability



MORE INFO



Lost persons and property

Lost persons or anyone finding or looking for lost property should report to the Aston Webb Reception, Aston Webb Building (R6). Tel: 0121 414 8130/8131 or contact a student ambassador.

First aid

First aid assistance can be found at the Aston Webb Reception, Aston Webb Building (R6). Tel: 0121 414 8130/8131.

Emergencies and Security

To summon an ambulance and/or police dial 999 first and then inform Security Control on 0121 414 4444.

In the event of a fire contact Security Control on 0121 414 4444. To summon University Security Services for incidents not requiring the Emergency Services dial 0121 414 3000.

The city of Birmingham

BIRMINGHAM HAS BEEN TRANSFORMED INTO A CITY FOR YOUNG PROFESSIONALS AND IS ONE OF EUROPE'S MOST EXCITING DESTINATIONS.

IT IS MORE THAN SOMEWHERE TO STUDY; IT IS SOMEWHERE TO BUILD A SUCCESSFUL CAREER.

Birmingham is a modern and fascinating city: famous for its historic industrial past, it is now a centre of arts and culture, commerce and entertainment, with a vibrant and diverse community. Home to some of the biggest concerts and sporting events in the country, Birmingham has various large arenas, theatres, sports clubs and one of Europe's finest concert halls. The city hosts a wealth of shopping experiences including the iconic Bullring, the brand new Grand Central, and a range of independent shops across the city. If you'd rather spend your time testing new cuisines, Birmingham was named Britain's 'foodiest town' by *The New York Times*. Whether you'd prefer the lively atmosphere on Broad Street or the laid-back feel of Brindleyplace, where you can enjoy beautiful views of the canal; there is always something new and exciting to explore in Birmingham.

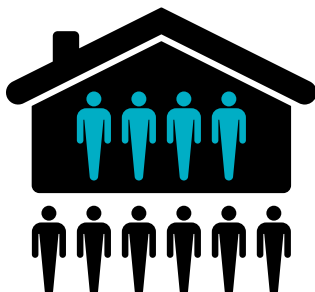

Around **40%** of Birmingham graduates choose to make their home here after leaving University

BIRMINGHAM EXPERIENCE

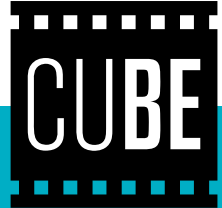

The Birmingham Experience Cube

Experience the best of both worlds when you visit us for an open day.

Find out more about the history, culture and vibrancy of the city of Birmingham; straight from our glorious leafy campus.

Make sure you visit our Birmingham Experience Cube on Chancellor's

Court, where you will be immersed in exciting locations around the city. Lose yourself in the places you'll be spending your time when you choose Birmingham, and once you've had a taste of the city; go and experience it for yourself!



General events timetable

Talks last approximately 30 minutes.

Please note this programme is subject to change.

Activity	Description	Time(s)	Venue	Map
Accommodation (LIVING stand)	Display and information desk	All day	Great Hall, Ground Floor, Aston Webb Building	R6
Accommodation	Talks	9.45am 11.15am	Main Lecture Theatre, Lower Ground, Aston Webb Building	R6
Accommodation	Talks	12.45pm 1.30pm	Elgar Concert Hall, Ground Floor, Bramall Building	R12
Accommodation	Viewing	9.00am–3.15pm (busiest periods between 11.00am and 2.30pm)	Bus departs from outside the Barber Institute of Fine Arts	R14
Admissions	Display and information desk	All day	Great Hall, Ground Floor, Aston Webb Building	R6
Barber Institute of Fine Arts	Art gallery	11.00am–5.00pm	Barber Institute of Fine Arts	R14
Big Brum Bus Tour (Birmingham sightseeing)	Tickets from Aston Webb Reception (R6) on a first-come, first-served basis	2.30pm 3.45pm	Bus will pick up and drop off outside the Barber Institute of Fine Arts	R14
Birmingham International Academy	Literature on academic English language support for international students available on the Study Abroad and Exchanges stand	All day	Great Hall, Ground Floor, Aston Webb Building	R6
Campus tours	Guided walking tours of the main campus	All day	Chancellor's Court	M
Careers Network	Display and information desk	All day	Great Hall, Ground Floor, Aston Webb Building	R6
Careers Network	Talks – Time to make the most of your Birmingham degree: internships, work experience, bursaries and graduate career success	10.30am 12.45pm 2.15pm	Careers Network Seminar Room G30, Ground Floor, Aston Webb Building	R6
Disability, Learning Support and Mental Health	Display and information desk	All day	Great Hall, Ground Floor, Aston Webb Building	R6
The Engineering Development Trust (EDT)	Talk – Year in Industry (YINI) Paid degree relevant placements for gap year students: engineering, science and computing	11.15am	Lecture Theatre G13, Ground Floor, Nuffield	R9
The Engineering Development Trust (EDT)	Display and information desk	All day	Great Hall, Ground Floor, Aston Webb Building	R6
Funding, Graduation and Awards – Money Matters	Display and information desk	All day	Great Hall, Ground Floor, Aston Webb Building	R6

Activity	Description	Time(s)	Venue	Map
Funding, Graduation and Awards – Money Matters	Talks – An overview of the statutory support available to UK/EU undergraduates including application, interest and repayment; plus available bursaries and scholarships	10.30am 3.00pm	Lecture Theatre WG5, Ground Floor, Aston Webb Building	R6
		12.45pm 2.15pm	Main Lecture Theatre, Lower Ground Floor, Aston Webb Building	R6
Gallery tour	Guided tour of the Barber Institute's art and coin collections	12.00noon	Foyer, Ground Floor, Barber Institute of Fine Arts	R14
Guild of Students	Display and information desk	All day	Foyer, Guild of Students	01
Guild of Students	Display and information desk	All day	Great Hall, Ground Floor, Aston Webb Building	R6
International students	Talk – Opportunities for international students	11.15am	Lecture Theatre WG12, Ground Floor, Aston Webb Building	R6
Joint Honours (Arts disciplines)	Talks – Joint Honours in Arts Disciplines at Birmingham (refer to page 14 for subject list)	10.30am 2.15pm	Lecture Room 6, 2nd Floor, Arts Building	R16
Joint Honours (Arts disciplines)	Display and information desk – Admissions to Joint Honours in Arts disciplines (refer to page 14 for subject list)	All day	The Dome Room, 3rd Floor, Bramall Music Building	R12
Languages for all	Talk – Language courses in the institution-wide language programme (Modules Outside the Main Discipline and extracurricular)	1.30pm	Lecture Room 5, 2nd Floor, Arts Building	R16
Languages for all	Display and information desk	All day	Foyer, Ground Floor, Bramall Music Building	R12
Library Services	Displays and visualisations (meet library staff and ask questions about the new build and our services)	9.30am–3.00pm	Foyer, Ground Floor, New Library	R30
Parents – support and guidance	Talks – Parents' Survival Guide	1.30pm	Lecture Theatre WG5, Ground Floor, Aston Webb Building	R6
Security	Display and information desk	All day	Great Hall, Ground Floor, Aston Webb Building	R6
Sport (University of Birmingham Sport)	Display and information desk	All day	Great Hall, Ground Floor, Aston Webb Building	R6
Sport (University of Birmingham Sport)	Find out more about 360 Sport & Fitness, chat to our clubs and coaches	All day	Sport Marquee, outside the Guild of Students	01
Sport (University of Birmingham Sport)	Talks – Sport and Fitness at Birmingham	9.45am, 11.15am, 12.45pm, 2.15pm	Sport Marquee, outside the Guild of Students	01
Student groups	Display and information desk	All day	Guild of Students	01

Activity	Description	Time(s)	Venue	Map
Student life	Talks – Student Life by Students followed by optional tour of the Guild Find us online at www.guildofstudents.com and follow us on Twitter @GuildofStudents	11.15am 12.00noon 1.30pm 2.15pm	Debating Hall, 1st Floor, Guild of Students	01
Study Abroad and Exchanges	Display and information desk	All day	Great Hall, Ground Floor, Aston Webb Building	R6
Study Abroad and Exchanges	Talks – Opportunities to study abroad as part of your Birmingham degree	12.00noon 2.15pm	Concert Hall, Ground Floor, Barber Institute of Fine Arts	R14
Teachers Forum	This is a ticketed event for teachers who have booked a place	11.15am	Lecture Theatre WG5, Ground Floor, Aston Webb Building	R6
Tips for applicants	Talks	10.30am 12.00noon 1.30pm 3.00pm	Main Lecture Theatre, Lower Ground Floor, Aston Webb Building	R6
University Music Society	Display and information desk – come and meet your music society!	All day	The Dome Room, 3rd Floor, Bramall Music Building	R12
Welcome and tips for your day	Talks	9.45am 10.30am	Elgar Concert Hall, Bramall Music Building	R12
Winterbourne House and Garden	Edwardian house and garden with tea room open for visitors	10.00am–5.30pm on Friday and 11.00am–5.30pm on Saturday	Winterbourne House and Garden	G12
Year in Industry	Display and information – please visit Business Management stand	All day	Great Hall, Ground Floor, Aston Webb Building	R6

What type of programme suits you?

Single Honours

This type of programme focuses on one subject only, such as LLB Law or BSc Physiotherapy. The subject events timetable lists the variety of subjects available.

Liberal Arts and Natural Sciences

Using the breadth of academic expertise from across the University, this degree allows you to design your own programme of study based on your interests and strengths. You will be supported in choosing modules which fit together into a logical programme of study reflecting your developing interests and knowledge. You will typically choose a Major area of expertise selected from a range of subjects across the University.

Joint Honours

A Joint Honours degree allows you to study two subjects. This might be two subjects closely related to each other, such as History and Politics; or simply two which you enjoy equally, such as French and Mathematics.

RECOMMENDED TALK

Studying Liberal Arts and Natural Sciences at Birmingham, **12.00noon, Lecture Theatre G51, Ground Floor, European Research Institute (G3).**

RECOMMENDED TALK

Joint Honours in Arts Disciplines at Birmingham (all Joint Honours combinations involving at least one of the following subjects: American and Canadian Studies; Drama; English; Ancient History and Archaeology; Classical Literature and Civilisation; History; Anthropology; African Studies; French; German; Spanish; Russian; Theology; Philosophy; History of Art, and Music), **10.30am and 2.15pm, Lecture Theatre 6, 2nd Floor, Arts Building (R16).**

Subject events timetable

Talks last approximately 30 minutes.
Please note this programme is subject to change.

	Arts and Law
	Engineering and Physical Sciences
	Medical and Dental Sciences
	Life and Environmental Sciences
	Social Sciences

A				
Subject	Description	Time(s)	Venue	Map
Accountancy (KPMG)	Display and information desk	All day	Great Hall, Ground Floor, Aston Webb Building	R6
Accounting and Finance	Display and information desk	All day	Great Hall, Ground Floor, Aston Webb Building	R6
Accounting and Finance	Display and information desk	All day	Atrium/Reception, Ground Floor, University House	03
Accounting and Finance	Talks – BSc Accounting and Finance degree at Birmingham Business School	9.45am 11.15am 12.45pm	Lecture Theatre G12, Ground Floor, University House	03
African Studies	Display and information desk – African Studies and Anthropology	All day	The Dome Room, 3rd Floor, Bramall Music Building	R12
African Studies	Talks – African Studies, Anthropology and Development at Birmingham	12.00noon 2.15pm	Danford Room, Room 224, 2nd Floor, Arts Building	R16
American and Canadian Studies	Display and information desk	All day	Rotunda, 1st Floor, Bramall Music Building	R12
American and Canadian Studies	Taster Lecture – What is American and Canadian Studies?	11.15am	Lecture Room 3, 1st Floor, Arts Building	R16
American and Canadian Studies	Talk – American and Canadian Studies programmes overview	1.30pm	Lecture Room 3, 1st Floor, Arts Building	R16
Ancient and Medieval History	Display and information desk – History	All day	The Dome Room, 3rd Floor, Bramall Music Building	R12
Ancient and Medieval History	Talk – Ancient and Medieval History at Birmingham	12.00noon	Lecture Room 3, 1st Floor, Arts Building	R16
Ancient and Medieval History	Talk – Ancient and Medieval History at Birmingham	1.30pm	Lecture Room 7, 2nd Floor, Arts Building	R16
Ancient History	Display and information desk – Classics, Ancient History and Archaeology	All day	The Dome Room, 3rd Floor, Bramall Music Building	R12
Ancient History	Talk – Ancient History at Birmingham	11.15am	Lecture Room 1, 1st Floor, Arts Building	R16
Ancient History	Taster Sessions – Ancient Language	10.30am 1.30pm	CAHA Museum, Room 304/5, 3rd Floor, Arts Building	R16
Anthropology	Display and information desk – African Studies and Anthropology	All day	The Dome Room, 3rd Floor, Bramall Music Building	R12
Anthropology	Talks – African Studies, Anthropology and Development at Birmingham	12.00noon 2.15pm	Danford Room, Room 224, 2nd Floor, Arts Building	R16
Anthropology	Talk – Archaeology and Anthropology	3.00pm	CAHA Museum, Room 304/5, 3rd Floor, Arts Building	R16
Applied Golf Management Studies	Display and information desk	All day	Great Hall, Ground Floor, Aston Webb Building	R6
Applied Golf Management Studies	Display and information desk	All day	Atrium, Ground Floor, Sport, Exercise and Rehabilitation Sciences Building	Y14

A (continued)				
Subject	Description	Time(s)	Venue	Map
Applied Golf Management Studies	Talks – Studying Applied Golf Management Studies	11.15am 1.30pm	Room G86, Ground Floor, Sport, Exercise and Rehabilitation Sciences Building	Y14
Archaeology	Display and information desk – Classics, Ancient History and Archaeology	All day	The Dome Room, 3rd Floor, Bramall Music Building	R12
Archaeology	Talk – Archaeology and Ancient History at Birmingham	12.00noon	Lecture Room 1, 1st Floor, Arts Building	R16
Archaeology	Talk – Archaeology and Anthropology	3.00pm	CAHA Museum, Room 304/5, 3rd Floor, Arts Building	R16
Arts	Talks – Joint Honours in Arts Disciplines at Birmingham	10.30am 2.15pm	Lecture Room 6, 2nd Floor, Arts Building	R16
Arts	Display and information desk – Joint Honours (Arts Disciplines)	All day	The Dome Room, 3rd Floor Bramall Music Building	R12

B				
Subject	Description	Time(s)	Venue	Map
Biomedical Materials Science	Talks – The BMedSc Biomedical Materials Science course	10.30am 12.45pm	Lecture Theatre 3, 1st Floor, Medical School	B1
Biomedical Materials Science	Tours of the new Dental Hospital and School of Dentistry Tickets can be collected on a first-come, first-served basis from the School of Dentistry stand in the Common Room. Tours last approximately one hour	10.30am 12.00noon 2.15pm	Collect tickets from Common Room, Ground Floor, Wolfson Centre for Medical Education, Medical School	B1
Biomedical Materials Science	Display and information desk with admissions tutor	All day	Common Room, Ground Floor, Wolfson Centre for Medical Education, Medical School	B1
Biomedical Science	Display and information desks with admissions tutor	All day	Common Room, Ground Floor, Wolfson Centre for Medical Education, Medical School	B1
Biomedical Science	Student Life: A talk by students from different programmes including Biomedical Science	9.00am 12.00noon 2.15pm	Leonard Deacon Lecture Theatre, First Floor, Medical School	B1
Biomedical Science	Talks – The BSc Biomedical Science Course	11.15am 1.30pm	Arthur Thompson Hall, 3rd Floor, Medical School	B1
Biosciences	Display and information desk for Biochemistry, Biological Sciences and Human Biology	All day	Great Hall, Ground Floor, Aston Webb Building	R6
Biosciences	Display and information desk for Biochemistry, Biological Sciences and Human Biology	All day	Foyer, Biosciences Building	R27
Biosciences	Open teaching lab demonstrations	10.00am– 3.00pm	Room 201, 2nd Floor, Biosciences Building	R27
Biosciences	Talks – Overview of Biosciences undergraduate courses	9.45am 2.15pm	Lecture Theatre NG08, Ground Floor, Biosciences Building	R27
Biosciences	Talks – Careers in Biosciences	10.30am 1.30pm	Lecture Theatre NG08, Ground Floor, Biosciences Building	R27
Biosciences	Talks – Introduction to Biological Sciences	11.15am 12.45pm	Lecture Theatre NG08, Ground Floor, Biosciences Building	R27

B (continued)				
Subject	Description	Time(s)	Venue	Map
Biosciences	Talks – Introduction to Biochemistry	11.15am 12.45pm	Lecture Theatre E102, 1st Floor, Biosciences Building	R27
Biosciences	Talks – Introduction to Human Biology	11.15am 12.45pm	Lecture Theatre 301, 3rd Floor, Biosciences Building	R27
Biosciences	Talks – Taster lecture	10.30am 12.00noon 1.30pm	Lecture Theatre E102, 1st Floor, Biosciences Building	R27
Business Management (Pathways)	Display and information desk	All day	Great Hall, Ground Floor, Aston Webb Building	R6
Business Management (Pathways)	Display and information desk	All day	Atrium/Reception, Ground Floor, University House	03
Business Management	Talks – BSc Business Management (Pathways) degrees at Birmingham Business School	10.30am 12.00noon 1.30pm	Lecture Theatre G12, Ground Floor, University House NB: orange section of the campus map	03
C				
Subject	Description	Time(s)	Venue	Map
Chemical Engineering	Display and information desk	All day	Great Hall, Ground Floor, Aston Webb Building	R6
Chemical Engineering	Display and information desk	All day	Foyer, Ground Floor, Chemical Engineering Building	Y11
Chemical Engineering	Engineering welcome	9.45am	Room G31, Ground Floor, Civil and Mechanical Engineering Building	Y3
Chemical Engineering	Talks – Chemical engineering products for the consumer	11.15am 2.15pm	Room 124, 1st Floor, Chemical Engineering Building	Y11
Chemical Engineering	Tours of Chemical Engineering will take place after each talk	11.45am 2.45pm	Room 124, 1st Floor, Chemical Engineering Building	Y11
Chemistry	Displays and hands-on experiments	All day	209a (Seminar Room), 1st Floor, Haworth Building	Y2
Chemistry	Displays and information desk	All day	216 (Reading Room), 1st Floor, Haworth Building	Y2
Chemistry	Display and information desk	All day	Great Hall, Ground Floor, Aston Webb Building	R6
Chemistry	Student-led tours of the department	All day	209, 1st Floor, Haworth Building	Y2
Chemistry	Talks – Chemistry at Birmingham: an admissions tutor will talk about courses, entry requirements and scholarships	10.30am 1.30pm	Lecture Theatre 101, Ground Floor, Haworth Building	Y2
Chemistry	Talk – My student experience: short talks by Chemistry students and alumni followed by an open Q&A session	11.15am	Lecture Theatre 101, Ground Floor, Haworth Building	Y2
Chemistry	Talk – Chemical Magic: an interactive and amusing demonstration of chemistry by Ray Plevey	12.00noon	Lecture Theatre 101, Ground Floor, Haworth Building	Y2
Chemistry	Talk – Careers for graduate chemists and how Birmingham is developing key employability skills so our graduates can fulfil their career aspirations	12.45pm	Lecture Theatre 101, Ground Floor, Haworth Building	Y2

C (continued)				
Subject	Description	Time(s)	Venue	Map
Chemistry	Talk – chemistry and energy: from steam to nuclear power; an entertaining demonstration of chemistry in action	2.15pm	Lecture Theatre 101, Ground Floor, Haworth Building	Y2
Civil Engineering	Display and information desk	All day	Great Hall, Ground Floor, Aston Webb Building	R6
Civil Engineering	Display and information desk	All day	Shell Lounge, Ground Floor, Mechanical and Civil Engineering	Y3
Civil Engineering	Engineering welcome	9.45am	Room G31, Ground Floor, Civil and Mechanical Engineering Building	Y3
Civil Engineering	Talk – What can civil engineers do?	11.15am	Lecture Theatre G34, Ground Floor, Mechanical and Civil Engineering	Y3
Civil Engineering	Tours and demonstrations in our laboratories	11.30am 1.30pm	Shell Lounge, Ground Floor, Mechanical and Civil Engineering	Y3
Civil Engineering	Sample Lecture – Engineering Against Disaster	1.30pm	Lecture Theatre G34, Ground Floor, Mechanical and Civil Engineering	Y3
Classics	Display and information desk – Classics, Ancient History and Archaeology	All day	The Dome Room, 3rd Floor, Bramall Music Building	R12
Classics	Taster Sessions – Ancient Language	10.30am 1.30pm	CAHA Museum, Room 304/5, 3rd Floor, Arts Building	R16
Classics	Talk – Classics at Birmingham (including BA Classics and BA Classical Literature and Civilisation)	12.45pm	Lecture Room 3, 1st Floor, Arts Building	R16
College of Arts and Law Student Experience Team	Display and information desk – learn how the College of Arts and Law enhances the student experience for its students	All day	Rotunda, 1st Floor, Bramall Music Building	R12
Computer Science	Display, information desk and demonstrations	All day	Great Hall, Ground Floor, Aston Webb Building	R6
Computer Science	Displays, meet staff and current students, student-led tours of the department and demonstrations	All day	Atrium, Ground Floor, Computer Science Building	Y9
Computer Science	Talks – Why Computer Science at Birmingham?	10.30am	Lecture Room G31, Ground Floor, Mechanical and Civil Engineering	Y3
		1.30pm	Lecture Room G29, Ground Floor, Mechanical and Civil Engineering	Y3
Computer Science	Talk – Artificial Intelligence	11.15am	Lecture Room G29, Ground Floor, Mechanical and Civil Engineering	Y3
Computer Science	Talk – Cutting-edge computing	12.00noon	Lecture Room G29, Ground Floor, Mechanical and Civil Engineering	Y3
Computer Science	Q&A with Computer Science admissions team, current students and graduates	12.45pm	Lecture Room G29, Ground Floor, Mechanical and Civil Engineering	Y3
Creative Writing	See <i>English and Creative Writing</i>			

D				
Subject	Description	Time(s)	Venue	Map
Dental Hygiene and Therapy	Display and information desk with Admissions Tutor	All day	Common Room, Ground Floor, Wolfson Centre for Medical Education, Medical School	B1
Dental Hygiene and Therapy	Talks – BSc Dental Hygiene and Therapy	11.15am 1.30pm	Lecture Theatre 4, Ground Floor, Medical School	B1
Dental Surgery (BDS)	Display and information desk with admissions tutor (BDS)	All day	Common Room, Ground Floor, Wolfson Centre for Medical Education, Medical School	B1
Dental Surgery (BDS)	Talks – Dentistry at Birmingham (BDS)	9.45am 12.00noon 2.15pm	Arthur Thompson Hall, 3rd Floor, Medical School	B1
Dental Surgery, BMedSc and Dental Hygiene and Therapy	Tours of the new Dental Hospital and School of Dentistry Tickets can be collected on a first-come, first-served basis from the School of Dentistry stand in the Common Room. Tours last approximately one hour.	10.30am 12.00noon 2.15pm	Collect tickets from Common Room, Ground Floor, Wolfson Centre for Medical Education, Medical School	B1
Drama and Theatre Arts	Display and information desk	All day	Rotunda, 1st Floor, Bramall Music Building	R12
Drama and Theatre Arts	Talks – Drama at Birmingham and an opportunity to see the facilities at Selly Oak Campus. Places are first-come, first-seated. Bus departs 9.30am (back 11.00–11.15am); 11.15am (back 12.45–1.00pm); 1.30pm (back 3.00–3.15pm)	9.30am 11.15am 1.30pm	Bus departs promptly from North Gate semi-circle (please see map at back of this programme)	D

E				
Subject	Description	Time(s)	Venue	Map
Earth Sciences	<i>See Geology</i>			
Economics	Display and information desk	All day	Great Hall, Ground Floor, Aston Webb Building	R6
Economics	Display and information desk	All day	Atrium/Reception, Ground Floor, University House	03
Economics	Talks – Economics and related degrees	10.30am 11.15am	Concert Hall, Ground Floor, Barber Institute of Fine Arts	R14
Economics	Talk – Economics and related degrees	1.30pm	Lecture Theatre G31, Ground Floor, Mechanical Engineering Building	Y3
Education	Display and information desk	All day	Great Hall, Ground Floor, Aston Webb Building	R6
Education	Talks – Introduction to undergraduate programmes in the School of Education	11.15am 1.30pm	Lecture Theatre G33, Ground Floor, Education Building	R19
Electronic, Electrical and Systems Engineering	Display and information desk	All day	Great Hall, Ground Floor, Aston Webb Building	R6
Electronic, Electrical and Systems Engineering	Demonstrations and displays	All day	Room G36, Ground Floor, Mechanical and Civil Engineering Building	Y3
Electronic, Electrical and Systems Engineering	Engineering welcome	9.45am	Room G31, Ground Floor, Civil and Mechanical Engineering Building	Y3

E (continued)				
Subject	Description	Time(s)	Venue	Map
Electronic, Electrical and Systems Engineering	Talk – What do electronic, electrical and systems engineers do?	10.30am	Lecture Theatre G34, Mechanical and Civil Engineering Building	Y3
Electronic, Electrical and Systems Engineering	Taster Lecture – How do electrical engineers Learn?	2.15pm	Lecture Theatre G34, Mechanical and Civil Engineering Building	Y3
The Engineering Development Trust (EDT) (Gap Placements)	Talk – Year in Industry (YINI) Paid degree relevant placements for gap students: engineering, science and computing	11.15am	Room G13, Ground Floor, Nuffield Building	R9
English Literature, English Language and English and Creative Writing	Display and information desk	All day	Rotunda, 1st Floor, Bramall Music Building	R12
English Literature	Talks – English Literature at Birmingham (Single Honours English, Joint Honours English Literature)	9.45am 11.15am 12.45pm 3.00pm	Large Lecture Theatre, 1st Floor, Arts Building	R16
English Literature	Taster Lectures – English Literature	12.00noon 1.30pm	Large Lecture Theatre, 1st Floor, Arts Building	R16
English Language	Talk – English Language at Birmingham (Single and Joint Honours)	12.45pm	Lecture Room 1, 1st Floor, Arts Building	R16
English Language	Taster Lecture – English Language	1.30pm	Lecture Room 1, 1st Floor, Arts Building	R16
English and Creative Writing	Talks – English and Creative Writing at Birmingham	10.30am 2.15pm	Large Lecture Theatre, 1st Floor, Arts Building	R16
English, Drama and American and Canadian Studies	Meet current students and learn more about the different modules offered	All day	Rotunda, 1st floor, Bramall Music Building	R12
Environmental Sciences	Display and information desk	All day	Great Hall, Ground Floor, Aston Webb Building	R6
Environmental Sciences	Display and information desk	All day	Foyer, Ground Floor, Learning Centre	R28
Environmental Sciences	Talks – Environmental Sciences at Birmingham	11.15am 12.45pm	Lecture Room UG10, Upper Ground Floor, Learning Centre	R28
Environmental Sciences	Taster Lecture	11.45am 1.30pm	Lecture Room UG05, Upper Ground Floor, Learning Centre	R28
Environmental Sciences	Blimp demonstration	9.00am– 2.30pm	Outside, University Centre	R23
Environmental Sciences	Computer Practical	1.30pm	Lecture Room UG08, Ground Floor, Learning Centre	R28
Environmental Sciences	Demonstrations	9.00am– 2.30pm	Upper Ground Floor, Learning Centre	R28

F				
Subject	Description	Time(s)	Venue	Map
French Studies	<i>See Modern Languages</i>			
G				
Subject	Description	Time(s)	Venue	Map
Geography	Demonstrations	9.00am–2.30pm	Upper Ground Floor, Learning Centre	R28
Geography	Display and information desk	All day	Foyer, Ground Floor, Learning Centre	R28
Geography	Display and information desk	All day	Great Hall, Ground Floor, Aston Webb Building	R6
Geography	Talks – Geography at Birmingham	9.00am 9.45am 10.30am 11.15am 12.00noon 12.45pm 1.30pm	Lecture Room UG09, Upper Ground Floor, Learning Centre	R28
Geography	Taster Lectures	9.30am 10.15am 11.00am 12.30pm 1.15pm 2.00pm	Lecture Room UG05, Upper Ground Floor, Learning Centre	R28
Geography	Computer Practical	10.30am 12.00noon	Lecture Room UG08, Ground Floor, Learning Centre	R28
Geography	Blimp demonstration	9.00am–2.30pm	Outside, University Centre	R23
Geology/Earth Sciences	Display and information desk	All day	Great Hall, Ground Floor, Aston Webb Building	R6
Geology/Earth Sciences	Display and information desk	All day	Foyer, Ground Floor, Learning Centre	R28
Geology/Earth Sciences	Practical Displays and Staff Discussions	9.00am–2.30pm	Lapworth Museum, Ground Floor, Aston Webb Building	R4
Geology/Earth Sciences	Talks – Earth Sciences at Birmingham and beyond	9.45am 11.15am 12.45pm	Lecture Room UG07, Upper Ground Floor, Learning Centre	R28
Geology/Earth Sciences	Taster Lecture	12.00noon	Earth Imaging Lab (via Lapworth Museum), Ground Floor, Aston Webb Building	R4
Geology/Earth Sciences	Earth Sciences Practical Demonstrations	10.30am 1.30pm	Earth Imaging Lab (via Lapworth Museum), Ground Floor, Aston Webb Building	R4
German Studies	<i>See Modern Languages</i>			
Golf Management Studies	<i>See Applied Golf Management Studies</i>			

H				
Subject	Description	Time(s)	Venue	Map
Hispanic Studies	<i>See Modern Languages</i>			
History	Display and information desk	All day	The Dome Room, 3rd Floor, Bramall Music Building	R12
History	Talks – History at Birmingham	9.45am 11.15am 12.45pm 2.15pm	Vaughan Jeffreys Lecture Theatre, 1st Floor, Education Building	R19
History	Taster Lecture – History	1.30pm	Vaughan Jeffreys Lecture Theatre, 1st Floor, Education Building	R19
History of Art	Display and information desk	All day	Rotunda, 1st Floor, Bramall Music Building	R12
History of Art	Tour of the Barber Institute of Fine Arts	12.00noon	Foyer, Ground Floor, Barber Institute of Fine Arts	R14
History of Art	Talk – History of Art at Birmingham	12.45pm	Lecture Theatre G11, Ground Floor, Barber Institute of Fine Arts	R14
History of Art	Taster session – History of Art	1.30pm	Foyer, Ground Floor, Barber Institute of Fine Arts	R14
Human Neuroscience	<i>See Psychology</i>			

I				
Subject	Description	Time(s)	Venue	Map
Italian Studies	<i>See Modern Languages</i>			

J				
Subject	Description	Time(s)	Venue	Map
Joint Honours (Arts disciplines)	Talks – Joint Honours in Arts Disciplines at Birmingham (refer to page 14 for subject list)	10.30am 2.15pm	Lecture Room 6, 2nd Floor, Arts Building	R16
Joint Honours (Arts disciplines)	Display and information desk – Admissions to Joint Honours in Arts disciplines (refer to page 14 for subject list)	All day	The Dome Room, 3rd Floor, Bramall Music Building	R12

L				
Subject	Description	Time(s)	Venue	Map
Law	Display and information desk	All day	Rotunda, 1st Floor, Bramall Music Building	R12
Law	Talk – Studying Law at Birmingham	9.45am 11.15am 12.00noon 1.30pm	Lecture Theatre 1, 3rd Floor, Law Building	R1
Law	Talk – Street Law – See our Pro Bono Group in action	10.30am 2.15pm	Lecture Theatre 2, 2nd Floor, Law Building	R1
Liberal Arts and Natural Sciences (LANS)	Talk – Studying Liberal Arts and Natural Sciences at Birmingham	12.00noon	Lecture Theatre G51, Ground Floor, European Research Institute	G3
Liberal Arts and Natural Sciences	Talk – Liberal Arts and Natural Sciences – The Student Experience (Q&A with LANS students)	1.30pm	Lecture Theatre G51, Ground Floor, European Research Institute	G3

L (continued)				
Subject	Description	Time(s)	Venue	Map
Liberal Arts and Natural Sciences	Display and information desk	All day	Great Hall, Ground Floor, Aston Webb Building	R6

M				
Subject	Description	Time(s)	Venue	Map
Materials Science and Engineering	Display and information desk	All day	Great Hall, Ground Floor, Aston Webb Building	R6
Materials Science and Engineering	Exhibition – Materials Science and Engineering at the University of Birmingham	All day	C Block Foyer, Metallurgy and Materials Building	G6
Materials Science and Engineering	Engineering welcome	9.45am	Room G31, Ground Floor, Mechanical and Civil Engineering	Y3
Materials Science and Engineering	Tours of building and facilities	11.15am 12.45pm 2.15pm	C Block Foyer, Metallurgy and Materials Building	G6
Materials Science and Engineering	Talk – Superconductivity and magnetism (includes demo)	10.30am	Lecture Room GC13, Ground Floor, Metallurgy and Materials Building	G6
Materials Science and Engineering	Talk – In pursuit of smarter materials (includes demo)	11.15am	Lecture Room GC13, Ground Floor, Metallurgy and Materials Building	G6
Materials Science and Engineering	Talk – What is Materials Science and Engineering? What is it like to study at Birmingham?	12.00noon	Lecture Room GC13, Ground Floor, Metallurgy and Materials Building	G6
Materials Science and Engineering	Talk – Life or death by materials science: the role of materials science in sports	12.45pm	Lecture Room GC13, Ground Floor, Metallurgy and Materials Building	G6
Materials Science and Engineering	Talk – What happens to materials in a nuclear power plant?	1.30pm	Lecture Room GD20, Ground Floor, Metallurgy and Materials Building	G6
Materials Science and Engineering	Talk – 3D printing for metals (includes demo)	2.15pm	Lecture Room GC13, Ground Floor, Metallurgy and Materials Building	G6
Materials Science and Engineering	Activity – Visit to the hydrogen-powered narrowboat	3.00pm	C Block Foyer, Metallurgy and Materials Building	G6
Mathematics	Meet academic staff and current students, find out more information about the courses and explore interactive displays, including a chocolate fountain and mathematical strategy games	All day	Maths Learning Centre, 1st Floor, Watson Building	R15
Mathematics	Talks – Why Mathematics at Birmingham?	9.45am 10.30am 12.45pm 2.15pm	Lecture Room A, Ground Floor, Watson Building	R15
Mathematics	Talk – Popular Maths Lecture: 'Fun, surprising and fascinating gems of Mathematics'	12.00noon	Lecture Room A, Ground Floor, Watson Building	R15
Mathematics	Talk – Popular Maths Lecture: 'Unusual, interesting and useful applications of Mathematics'	1.30pm	Lecture Room A, Ground Floor, Watson Building	R15
Mechanical Engineering	Display and information desk	All day	Great Hall, Ground Floor, Aston Webb Building	R6

M (continued)				
Subject	Description	Time(s)	Venue	Map
Mechanical Engineering	Display and information desk and start point for tours of the facilities (including racing car display)	All day	Room G28, Ground Floor, Mechanical and Civil Engineering	Y3
Mechanical Engineering	Engineering welcome	9.45am	Room G31, Ground Floor, Civil and Mechanical Engineering Building	Y3
Mechanical Engineering	Talk – Degree programmes in Mechanical Engineering	11.15am	Room G31, Ground Floor, Mechanical and Civil Engineering	Y3
Mechanical Engineering	Talk – What can mechanical engineers do?	12.45pm	Lecture Theatre G31, Ground Floor, Mechanical and Civil Engineering	Y3
Mechanical Engineering	Talk – Degree programmes in Mechanical Engineering	2.15pm	Lecture Theatre G29, Ground Floor, Mechanical and Civil Engineering	Y3
Medicine and Surgery (MBChB)	Talks – Student Life: a talk by students from different programmes including the Medical Society president	9.00am 12.00noon 2.15pm	Leonard Deacon Lecture Theatre, 1st Floor, Medical School	B1
Medicine and Surgery (MBChB)	Display and information desks with admissions tutor	All day	Common Room, Ground Floor, Wolfson Centre for Medical Education, Medical School	B1
Medicine and Surgery (MBChB)	Basic Life Support. Find out how our students train others in basic life support and receive training yourself.	10.00am– 2.00pm	Clinical Skills Suite, 1st Floor, Medical School	B1
Medicine and Surgery (MBChB)	Talks – The Medicine and Surgery (MBChB) programme. Please note that we may need to restrict access to the prospective applicant, with possibly one guest (least flexibility for 11.15am talk).	9.45am 11.15am 1.30pm	Leonard Deacon Lecture Theatre, 1st Floor, Medical School	B1
Medicine and Surgery (MBChB)	Talk – Graduate Entry Medicine Programme. The focus of this talk is on the programme structure in the first year.	10.30am	Lecture Theatre 4, Ground Floor, Medical School	B1
Modern Languages	Display and information desk (including representatives for French, German, Hispanic Studies, Italian, Chinese, Japanese and Russian Studies)	All day	The Dome Room, 3rd Floor, Bramall Music Building	R12
Modern Languages	Talks – BA Modern Languages at Birmingham including all modern languages pathways	11.15am 2.15pm	Lecture Theatre G15, Ground Floor, Muirhead Tower	R21
Modern Languages	Talk – Chinese at Birmingham	1.30pm	Lecture Room 2, 1st Floor, Arts Building	R16
Modern Languages	Talk – French Studies at Birmingham	12.45pm	Lecture Room 6, 2nd Floor, Arts Building	R16
Modern Languages	Sample seminar – French	1.30pm	Lecture Room 6, 2nd Floor, Arts Building	R16
Modern Languages	Talk – German Studies at Birmingham	11.15am	Lecture Room 7, 2nd Floor, Arts Building	R16
Modern Languages	Sample seminar – German	12.00noon	Lecture Room 7, 2nd Floor, Arts Building	R16

M (continued)				
Subject	Description	Time(s)	Venue	Map
Modern Languages	Talk – German for beginners or near beginners in language degrees or with language degrees	2.15pm	Lecture Room 2, 1st Floor, Arts Building	R16
Modern Languages	Talk – Hispanic Studies at Birmingham	10.30am	Lecture Room 7, 2nd Floor, Arts Building	R16
Modern Languages	Sample seminar – Hispanic Studies	2.15pm	Lecture Room 5, 2nd Floor, Arts Building	R16
Modern Languages	Talk – Italian Studies at Birmingham	12.00noon	Lecture Room 2, 1st Floor, Arts Building	R16
Modern Languages	Sample seminar – Italian	12.45pm	Lecture Room 2, 1st Floor, Arts Building	R16
Modern Languages	Talk – Japanese at Birmingham	12.45pm	Lecture Room 5, 2nd Floor, Arts Building	R16
Modern Languages	Talk – Russian Studies at Birmingham	11.15am	Lecture Room 5, 2nd Floor, Arts Building	R16
Modern Languages	Sample seminar – Russian	12.00noon	Lecture Room 5, 2nd Floor, Arts Building	R16
Music	Display and information desk	All day	The Dome Room, 3rd Floor, Bramall Music Building	R12
Music	Tours of the Bramall Music Building	1.30pm 2.00pm 2.30pm 3.00pm	Music Desk, The Dome Room, 3rd Floor, Bramall Music Building	R12
Music	Sample Seminar – Music	12.45pm	Concert Hall, Ground Floor, Barber Institute of Fine Arts	R14
Music	Talk – Music Studies at Birmingham	11.15am	Elgar Concert Hall, Bramall Music Building	R12

N				
Subject	Description	Time(s)	Venue	Map
Nuclear Engineering	Exhibition – Nuclear Engineering at the University of Birmingham	All day	C Block Foyer, Metallurgy and Materials Building	G6
Nuclear Engineering	Display and information desk	All day	Great Hall, Ground Floor, Aston Webb Building	R6
Nuclear Engineering	Exhibition – Year 1 Physics Laboratories	All day	Year 1 Labs, Ground Floor, Poynting Building	R13
Nuclear Engineering	Talk – What is nuclear engineering? What is it like to study it at Birmingham?	12.45pm	Lecture Room GD20, Ground Floor, Metallurgy and Materials Building	G6
Nuclear Engineering	Talk – What happens to materials in a nuclear power plant?	1.30pm	Lecture Room GD20, Ground Floor, Metallurgy and Materials Building	G6
Nuclear Engineering	Talk – Meeting the ever-growing demand for energy: nuclear power past, present and future	3.00pm	Small Lecture Theatre, 2nd Floor, Poynting Physics Building	R13
Nursing	Display and advice desk with admissions tutor	All day	Atrium, 1st Floor, Medical School	B1
Nursing	Clinical demonstrations	All day	Clinical Skills Suite, 1st Floor, Medical School	B1

N (continued)

Subject	Description	Time(s)	Venue	Map
Nursing	Talks – Applying for Nursing (BNurs)	9.45am 12.00noon 1.30pm	Lecture Theatre 3, 1st Floor, Medical School	B1

P

Subject	Description	Time(s)	Venue	Map
Pharmacy (MPharm)	Talks – The Pharmacy (MPharm) programme	10.30am 12.45pm	Arthur Thompson Hall, 3rd Floor, Medical School	B1
Pharmacy (MPharm)	Talks – Student Life: a talk by students from different programmes including Pharmacy	9.00am 12.00noon 2.15pm	Leonard Deacon Lecture Theatre, 1st Floor, Medical School	B1
Pharmacy (MPharm)	Display and information desk with admissions tutor	All day	Common Room, Ground Floor, Wolfson Centre for Medical Education, Medical School	B1
Philosophy	Display and information desk	All day	Rotunda, 1st Floor, Bramall Music Building	R12
Philosophy	Tours of the Department	10.30am 1.30pm	Reception, Ground Floor, Arts Building	R16
Philosophy	Talk – Philosophy at Birmingham	11.15am	Lecture Theatre 6, 2nd Floor, Arts Building	R16
Philosophy	Talk – Philosophy at Birmingham	2.15pm	Lecture Room 7, 2nd Floor, Arts Building	R16
Philosophy	Taster Lecture – Philosophy	12.00noon	Lecture Room 6, 2nd Floor, Arts Building	R16
Physics and Astronomy	Display and demonstrations	All day	First Year Lab, Ground Floor, Poynting Physics Building	R13
Physics and Astronomy	Why Physics at Birmingham?	All day	Coffee Lounge, 2nd Floor, Poynting Physics Building	R13
Physics and Astronomy	Talk – How to make an invisibility cloak	9.45am	Large Lecture Theatre, 2nd Floor, Poynting Physics Building	R13
Physics and Astronomy	Talk – Architecture with atoms	10.30am	Large Lecture Theatre, 2nd Floor, Poynting Physics Building	R13
Physics and Astronomy	Talks – Physics to a degree: studying Physics at the University of Birmingham	11.15am 1.30pm	Large Lecture Theatre, 2nd Floor, Poynting Physics Building	R13
Physics and Astronomy	Tour of Nanoscale Physics Research Lab (by registration only at physics-adms@contacts.bham.ac.uk)	11.15am	Meeting Point: Foyer, Ground Floor, Poynting Physics Building	R13
Physics and Astronomy	Talk – Refrigerators made from photons	12.00noon	Small Lecture Theatre, 2nd Floor, Poynting Physics Building	R13
Physics and Astronomy	Tours of teaching laboratories and facilities (by registration only at physics-adms@contacts.bham.ac.uk)	12.00noon 12.45pm 1.30pm	Meeting Point: Foyer, Ground Floor, Poynting Physics Building	R13
Physics and Astronomy	Talk – Sounding stars and the search for new planets in the Galaxy	12.45pm	Large Lecture Theatre, 2nd floor, Poynting Physics Building	R13
Physics and Astronomy	Talk – Recreating the Big Bang: the LHC at CERN	2.15pm	Large Lecture Theatre, 2nd Floor, Poynting Physics Building	R13

P (continued)				
Subject	Description	Time(s)	Venue	Map
Physics and Astronomy	Talk – Meeting the ever-growing demand for energy: nuclear power past, present and future	3.00pm	Small Lecture Theatre, 2nd Floor, Poynting Physics Building	R13
Physiotherapy	Display and information desk	All day	Great Hall, Ground Floor, Aston Webb Building	R6
Physiotherapy	Display and information desk	All day	Atrium, Ground Floor, Sport, Exercise and Rehabilitation Sciences Building	Y14
Physiotherapy	Talks – Applying for Physiotherapy at the University of Birmingham. Tickets for these talks are available from the Sport, Exercise and Rehabilitation Sciences Building Y14.	9.45am 10.30am 12.45pm 2.15pm	Lecture Theatre 2, Ground Floor, Sport, Exercise and Rehabilitation Sciences Building	Y14
Physiotherapy	Taster lecture – Tickets for this talk are available from the Sport, Exercise and Rehabilitation Sciences Building Y14	11.15am	Lecture Theatre 1, Ground Floor, Sport, Exercise and Rehabilitation Sciences Building	Y14
Physiotherapy	Taster Lecture – Tickets for this talk are available from the Sport, Exercise and Rehabilitation Sciences Building Y14	1.30pm	Lecture Theatre 2, Ground Floor, Sport, Exercise and Rehabilitation Sciences Building	Y14
Physiotherapy	Demonstrations	9.00am–3.00pm	Atrium, Ground Floor, Sport, Exercise and Rehabilitation Sciences Building	Y14
Political Science and International Relations	Display and information desk	All day	Great Hall, Ground Floor, Aston Webb Building	R6
Political Science and International Relations	Talks – Studying Politics and International Relations	10.30am 12.00noon 1.30pm	Lecture Theatre G15, Ground Floor, Muirhead Tower	R21
PPE (Policy, Politics and Economics)	Talk – Studying Policy, Politics and Economics (PPE)	2.15pm	Room 121, 1st Floor, Muirhead Tower	R21
PPE (Policy, Politics and Economics)	Display and information desk	All day	Great Hall, Ground Floor, Aston Webb Building	R6
Psychology (including Human Neuroscience)	Display and information desk	All day	Great Hall, Ground Floor, Aston Webb Building	R6
Psychology (including Human Neuroscience)	Display and information desk	All day	Reception, Ground Floor, Hills Building	R3
Psychology	Demonstrations	11.00am–2.00pm	Psychology 120, Ground Floor, Hills Building	R3
Psychology (Human Neuroscience)	Talks - Studying Human Neuroscience at Birmingham	11.15am 12.45pm	Lecture Theatre G17, Ground Floor, Nuffield Building	R9
Psychology	Taster lecture – Psychology	3.00pm	Vaughan Jeffreys Lecture Theatre, Ground Floor, Education Building	R19
Psychology	Talk – Studying Psychology at Birmingham	9.45am	Concert Hall, Ground Floor, Barber Institute of Fine Arts	R14
Psychology	Talk – Studying Psychology at Birmingham	10.30am	Vaughan Jeffreys Lecture Theatre, Ground Floor, Education Building	R19
Psychology	Talks – Studying Psychology at Birmingham	12.00noon 2.15pm	Elgar Concert Hall, Ground Floor, Bramall Music Building	R12

R				
Subject	Description	Time(s)	Venue	Map
Railway Engineering	Display and Information Desk	All day	Foyer, Ground Floor, Gisbert Kapp building	R8
Railway Engineering	Display and Information Desk	All day	Great Hall, Ground Floor, Aston Webb Building	R6
Railway Engineering	Engineering welcome	9.45am	Room G31, Ground Floor, Civil and Mechanical Engineering Building	Y3
Railway Engineering	Talk – What can railway engineers do? (Civil Engineering Pathway)	11.15am	Lecture Room G34, Ground Floor, Civil and Mechanical Engineering Building	Y3
Railway Engineering	Tours of the Railway Research Lab	12.00noon	Foyer, Ground Floor, Gisbert Kapp building	R8
Railway Engineering	Talks – What can railway engineers do? (Electronic, Electrical and Systems Pathway)	10.30am	Lecture Room G34, Ground Floor, Civil and Mechanical Engineering Building	Y3
Russian Studies	<i>See Modern Languages</i>			

S				
Subject	Description	Time(s)	Venue	Map
Social Policy	Display and information desk	All day	Great Hall, Ground Floor, Aston Webb Building	R6
Social Policy	Talk – Social Policy and Sociology Joint Honours and Social Policy and Criminology Joint Honours	11.15am	Room 714/715, 7th Floor, Muirhead Tower	R21
Social Policy	Talk – Social Policy programmes and the Professions	1.30pm	Room 714/5, 7th Floor, Muirhead Tower	R21
Social Work	Display and information desk	All day	Great Hall, Ground Floor, Aston Webb Building	R6
Social Work	Talk – Social Work at the University of Birmingham	12.45pm	Room 714/5, 7th Floor, Muirhead Tower	R21
Sociology	Display and information desk	All day	Great Hall, Ground Floor, Aston Webb Building	R6
Sociology	Talk – Sociology at Birmingham	12.45pm	Lecture Theatre G15, Ground Floor, Muirhead Tower	R21
Spanish	<i>See Modern Languages</i>			
Sport and Exercise Sciences	Display and information desk	All day	Great Hall, Ground Floor, Aston Webb Building	R6
Sport and Exercise Sciences	Display and information desk	All day	Atrium, Ground Floor, Sport, Exercise and Rehabilitation Sciences Building	Y14
Sport and Exercise Sciences	Demonstrations	10.30am–2.00pm	Atrium, Ground Floor, Sport, Exercise and Rehabilitation Sciences Building	Y14
Sport and Exercise Sciences	Talks – Studying in the School of Sport, Exercise and Rehabilitation Sciences. Tickets for these talks are available from the Sport, Exercise and Rehabilitation Sciences Building Y14.	9.45am 10.30am 12.00noon 1.30pm	Lecture Theatre 1, 1st Floor, Sport, Exercise and Rehabilitation Sciences Building	Y14
Sport and Materials Science	Display and information desk	All day	Great Hall, Ground Floor, Aston Webb Building	R6

S (continued)				
Subject	Description	Time(s)	Venue	Map
Sport and Materials Science	Exhibition – Sports and Materials Science at Birmingham	All day	C Block Foyer, Metallurgy and Materials Building	G6
Sport and Materials Science	Talk – What is Materials Science and Engineering?	12.00noon	Lecture Room GC13, Metallurgy and Materials Building	G6
Sport and Materials Science	Talk – Life or death by materials science: the role of materials science in sports	12.45pm	Lecture Room GC13, Metallurgy and Materials Building	G6
Sport and Materials Science	Talk – What is it like to study Sport and Materials Science at Birmingham?	1.30pm	Lecture Room GC13, Metallurgy and Materials Building	G6
Sport, Physical Education and Coaching Sciences	Display and information desk	All day	Great Hall, Ground Floor, Aston Webb Building	R6
Sport, Physical Education and Coaching Sciences	Display and information desk	All day	Atrium, Ground Floor, Sport, Exercise and Rehabilitation Sciences Building	Y14
Sport, Physical Education and Coaching Sciences	Talks – Studying in the School of Sport, Exercise and Rehabilitation Sciences. Tickets for these talks are available from the Sport, Exercise and Rehabilitation Sciences Building Y14.	9.45am 10.30am 12.00noon 1.30pm	Lecture Theatre 1, 1st Floor, Sport, Exercise and Rehabilitation Sciences Building	Y14
Sport, Physical Education and Coaching Sciences	Demonstrations	10.30am–2.00pm	Atrium, Ground Floor, Sport, Exercise and Rehabilitation Sciences Building	Y14
Sport (University of Birmingham Sport)	<i>See University of Birmingham Sport (page 13)</i>			

T				
Subject	Description	Time(s)	Venue	Map
Theology and Religion	Display and information desk	All day	Rotunda, 1st Floor, Bramall Music Building	R12
Theology and Religion	Talk – Theology and Religion programmes at Birmingham including BA Philosophy, Religion and Ethics, BA Politics, Religion and Philosophy	12.45pm	Lecture Room 7, 2nd Floor, Arts Building	R16
Theology and Religion	Tours of the Department	10.30am 1.30pm	Reception, Ground Floor, Arts Building	R16

U				
Subject	Description	Time(s)	Venue	Map
Urban and Regional Planning	Display and information desk	All day	Foyer, Ground Floor, Learning Centre	R28
Urban and Regional Planning	Display and information desk	All day	Great Hall, Ground Floor, Aston Webb Building	R6
Urban and Regional Planning	Talks – BSc Joint Honours degrees in Urban and Regional Planning	10.30am 12.00noon	Lecture Room UG10, Upper Ground Floor, Learning Centre	R28
Urban and Regional Planning	Demonstrations	9.00am–2.30pm	Upper Ground Floor, Learning Centre	R28

Refreshments

During peak times, avoid delays by referring to our traffic light coding for catering outlets.

- long queues are likely
- queues are possible
- queues are unlikely

Location	Facilities	Opening times
BBQ, Chancellor's Court (R24)	Serving a variety of hot BBQ food	9.00am–3.00pm
Bratby Bar, Ground Floor, Staff House (R24)	Freshly made baguettes to order, jacket potatoes, hot food; the bar is also the only place on campus to get real ale	9.30am–3.00pm (food), 11.30am–3.00pm (bar)
Café Aroma, 1st Floor, Staff House (R24)	Parents' haven, serving a selection of sandwiches and hot and cold drinks	9.00am–3.00pm
Café Go/Go Mex, Food Court, 1st Floor, University Centre (R23)	A 300-seat restaurant area providing handmade deli sandwiches, jacket potatoes and pre-packed sandwiches, plus a Mexican burrito bar	8.30am–4.30pm (Go Mex 10.30am–5.00pm)
Costa at The Guild of Students (O1)	Serving Costa hot and cold beverages, cakes and light snacks	9.00am–4.00pm
Coffee shop at The Bramall Music Building (R12)	Serving Costa 'Proud to Serve', sandwiches, cakes and light snacks	8.00am–4.30pm
Costa, University Centre (R23)	Serving Costa hot and cold beverages, cakes and light snacks	8.00am–6.00pm
Cyber Go, Ground Floor, Arts Building (R16)	Coffee shop providing a range of coffees, sandwiches, Paninis, confectionery and cold drinks	9.00am–3.30pm
JC's, Chamberlain, Vale Village	Serving a range of hot and cold drinks	9.00am–3.00pm
Farmers market (clock tower)	A range of stalls providing hot food	10.00am–3.00pm
Gisbert Kapp (G8)	Serving a range of street food, coffees, sandwiches, Paninis, snacks, confectionery and cold drinks	9.00am–3.30pm
Go 2, Learning Resource Centre (R28)	Coffee shop providing a range of coffees, sandwiches, Paninis, confectionery and cold drinks	9.00am–4.00pm
Go Central, University Centre (R23)	Serves breakfast, Asian, Italian and British cuisine	8.00am–4.00pm
Go @ undercroft, Ground Floor, Biosciences Building (R27)	A coffee shop providing a large range of speciality coffees, sandwiches, snacks, confectionery and cold drinks	9.00am–3.00pm
iLounge (R22)	Coffee shop providing paninis, pastries, sandwiches, salad, smoothies and a wide selection of cakes	9.00am–4.00pm
Infusion, The Hub, Shackleton, Vale Village	Serving a hot lunch including bacon baps	9.00am–4.00pm
Joes Bar at The Guild of Students (O1)	Serves bar food, soft and alcoholic drinks	9.00am–4.00pm
Medical School (B1)	Providing a range of catering options, hot and cold food, deli, bakery and Costa Coffee	9.00am–4.00pm
Mechanical and Civil Engineering (Y3)	A coffee shop providing soup, a large range of speciality coffees, sandwiches, confectionery and cakes	10.00am–2.00pm
Empire Dogs (R23)	Serving a range of hot dogs	11.00am–3.00pm

Physics, Poynting Building, 2nd Floor (R13)	Coffee shop providing a range of coffees, sandwiches, Paninis, confectionery and cold drinks	9.00am–4.00pm
Skool Café, School of Education (R19)	A coffee shop providing a range of speciality coffees, sandwiches, confectionery and cakes	8.30am–3.00pm
Spar at The Guild of Students (O1)	A shop selling a selection of sandwiches and bakery goods	9.00am–4.00pm
Sportex (Sport, Exercise and Rehabilitation Sciences) (Y14)	Serving Costa 'Proud to Serve', sandwiches, cakes and light snacks	9.00am–3.00pm
Starbucks, Muirhead Tower (R21)	Popular coffee house serving a wide selection of quality coffees and food options	8.00am–5.00pm
Subway at The Guild of Students (O1)	Serving a selection of sandwiches	9.00am–4.00pm
The Melt, The Hub, Shackleton, Vale Village	Serving pastries and coffee	8.30am–4.00pm
Winterbourne House and Garden Tea Room (G12)	A popular tea room providing a variety of hot and cold meals. Entry to the house and garden is required.	11.00am–4.30pm



Day planner

The day planner is designed to help make sure you are able to visit all of the activities and areas you would like to on the day.

Time	Talk/activity	Location	Map building ref
9.00am			
9.15am			
9.30am			
9.45am			
10.00am			
10.15am			
10.30am			
10.45am			
11.00am			
11.15am			
11.30am			
11.45am			
12.00noon			
12.15pm			
12.30pm			
12.45pm			
1.00pm			
1.15pm			
1.30pm			
1.45pm			
2.00pm			
2.15pm			
2.30pm			
2.45pm			
3.00pm			
3.15pm			
3.30pm			
3.45pm			



key

- | | |
|----------------------------|---|
| Open day information point | ATM |
| Level access entrance | Canal bridge |
| Steps | Rail |
| Visitors car park | Average walk time from Chancellor's Court |
| Bus stops | General information point |
| Library | Check-in here |
| Museum | Campus tours |
| Sport facilities | Accommodation bus stop |
| First aid | Shuttle bus to Park and Ride |
| Food and drink | Drama and Theatre Arts talks bus pick up |
| Retail | Sport Marquee |
| Toilets | |

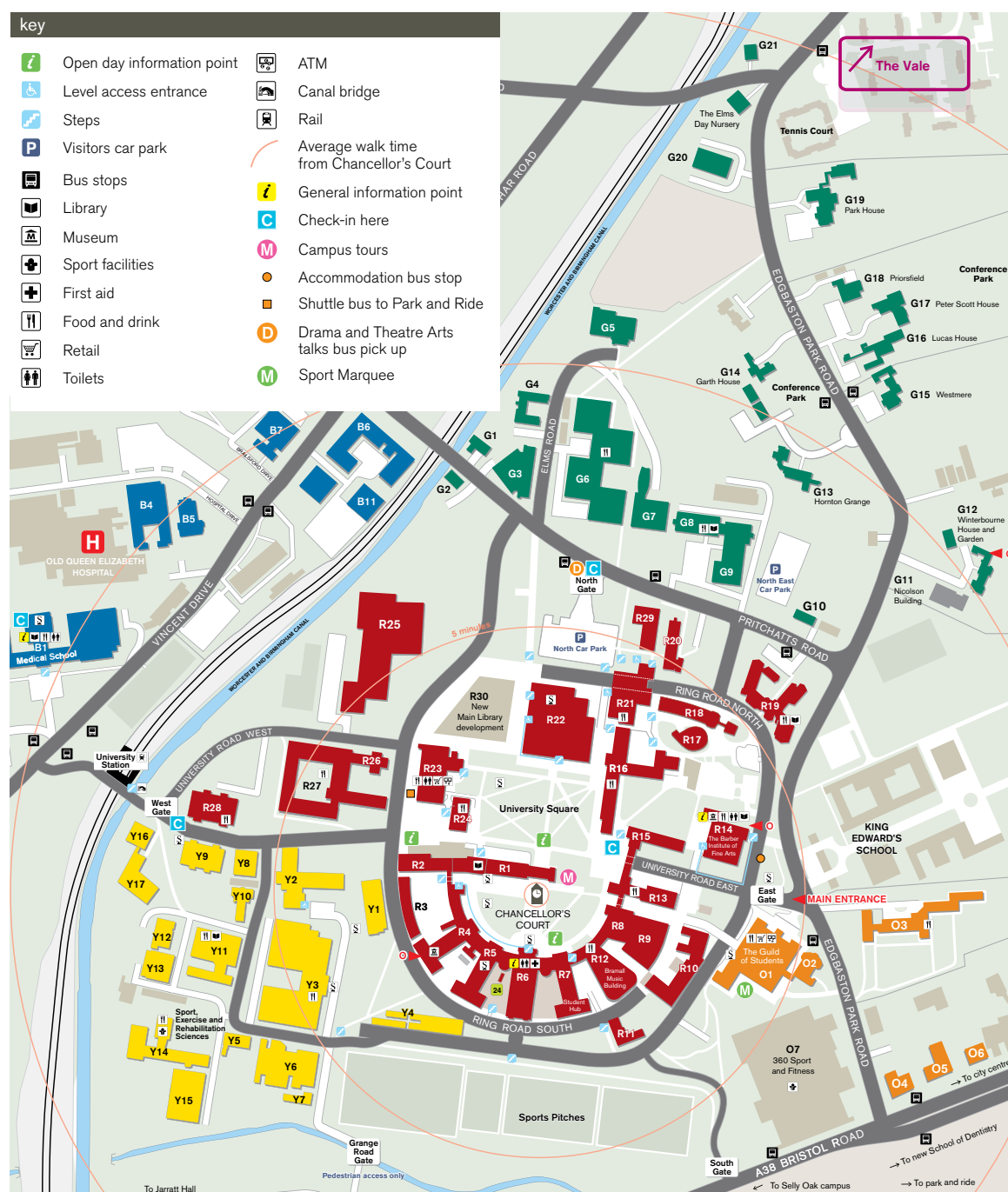

Please note some buildings do not appear on this map due to the size and scale. Larger maps will also be available on the day.

Edgbaston campus map key

R1	Law	R21	Muirhead Tower	Y2	Haworth Building Chemistry
R2	Frankland Building	R22	Main Library	Y3	Mechanical Engineering and Civil Engineering
R3	Hills Building Psychology	R23	University Centre Shops/Banks/Hair Salon/ Optician	Y9	Computer Science
R4	Aston Webb Building	R24	Staff House Refreshments	Y11	Chemical Engineering
R6	Aston Webb Building Reception Great Hall (displays) Lost Persons/Property First Aid	R27	Biosciences	Y14	Sport, Exercise and Rehabilitation Sciences
R12	Bramall Music Building 1st Floor Rotunda (displays) 3rd Floor Dome Room (displays)	R28	Learning Centre Geography, Earth and Environmental Sciences	B1	Medical School
R13	Poynting Building Physics	R30	New Main Library development	G3	European Research Institute
R14	Barber Institute of Fine Arts art gallery (Accommodation bus tours/Big Brum Bus Tour)	O1	Guild of Students (students' union) Debating Hall (talks) Shops/Banks/Travel Agent	G6	Metallurgy and Materials
R15	Watson Building Mathematics	O7	New Sports development	G8	Gisbert Kapp Building Electronic, Electrical and Computer Engineering
R16	Arts Building College of Arts and Law	O2	St Francis Hall Multi-faith Chaplaincy	G9	52 Pritchatts Road
R17	Ashley Building	O3	University House, Business School	G12	Winterbourne House and Garden
R19	Education Vaughan Jeffreys Lecture Theatre (talks)				

Maps with a more detailed index can be found on the University's website at www.birmingham.ac.uk/directions

For an interactive campus map, download the mobile app: www.birmingham.ac.uk/contact/app-store.aspx

